

# Wind-shade screen roll-up system

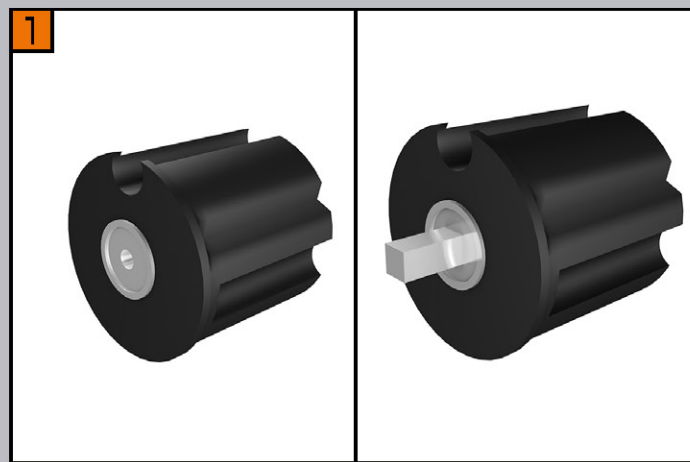

## 1) Bearing cap

- 63mm complete

## 1A) Mono cap

- 63mm complete

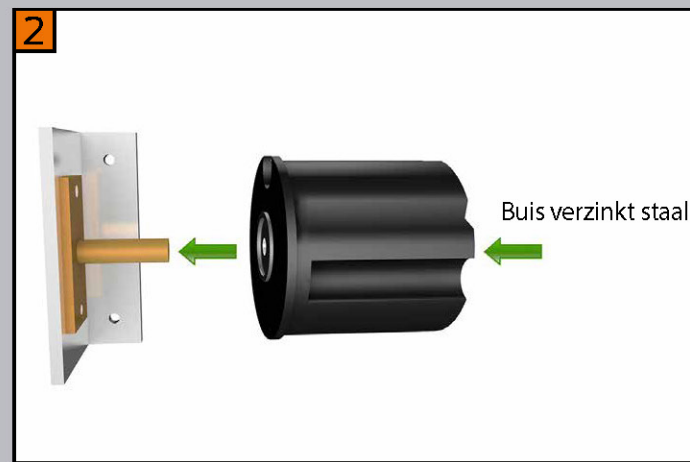

## 2) Support with bearing cap & bearing pin

- Aluminium support 40x80x4 mm for bearing pin
- Bearing pin 12mm galvanized steel
- Bearing cap 63mm
- Tube 63x0.9mm galvanized steel, you need to specify the length of the cloth.

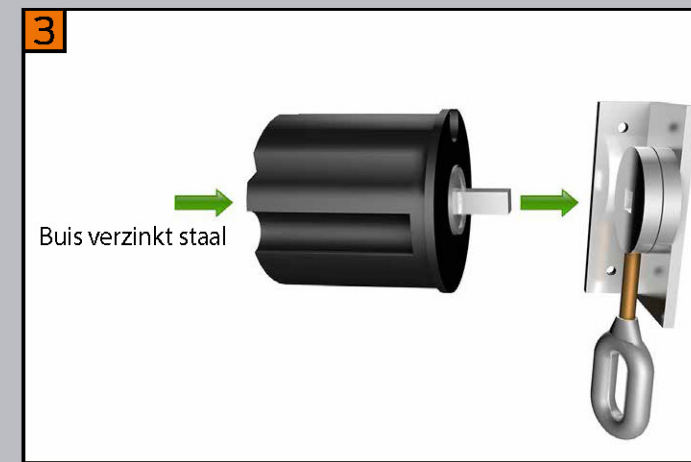

## 3) Support with mono cap & winding eye

- Aluminium support 40x80x4mm for winding eye
- Mono cap 63mm
- Winding eye 1:4 to roll up or unroll the cloth
- Crank rod 13x1.5mm, length 120 cm. When purchasing multiple cloths, you can choose to order only 1 crank rod.
- Tube 63x0.9mm galvanized steel, you need to specify the length of the cloth.

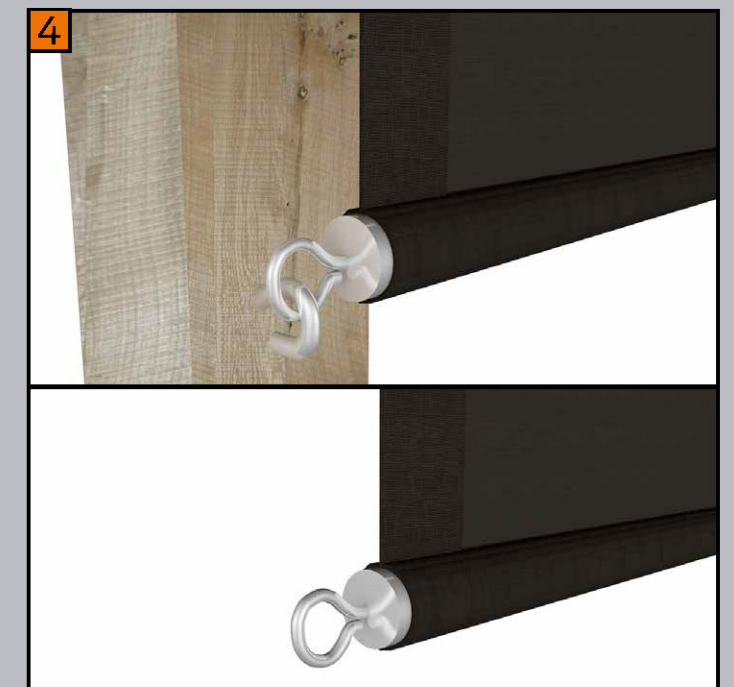

## 4) Tunnel with tube

- RVS tube 20x2.5mm as weight for the tunnel
- The cloth can be secured at any desired height; this requires the creation of fixation points.
- Tube length = cloth length
- The tube is delivered without a hook to attach it in the frame

